

Horizontal Wheel Test Stand

SH-220S with Distance Meter

SH-220 without Distance Meter

- Horizontal design is ideal for peel testing and other applications
- Hand wheel provides relatively consistent speed for repeatable tests
- Gauge remains in place when hand wheel is released
- One stand for both compression (push) and tension (pull) tests
- Continuous stroke 10"
- Maximum Load 220 lbf (100 kgf)



For doing peel tests and other force measurements where a horizontal stand is required, the SH-220 Manual Horizontal Hand Wheel Test Stand is an ideal choice. It has all of the advantages of the hand wheel design (relatively consistent speed, precise gauge positioning, bi-directional movement) in a low-profile horizontal package, the SH-220 accepts any of the standard range Imada force gauges and special attachments.

Distance Meter Specifications	
Display	Push button for inch/mm, zero set and on/off
Resolution	0.0005"/0.01mm
Accuracy	0.1% of reading or 0.005"/0.1mm, whichever is greater
Stroke	2"

AP-002 Adapter Plate is available to mount most other force gauges to IMADA test stands.

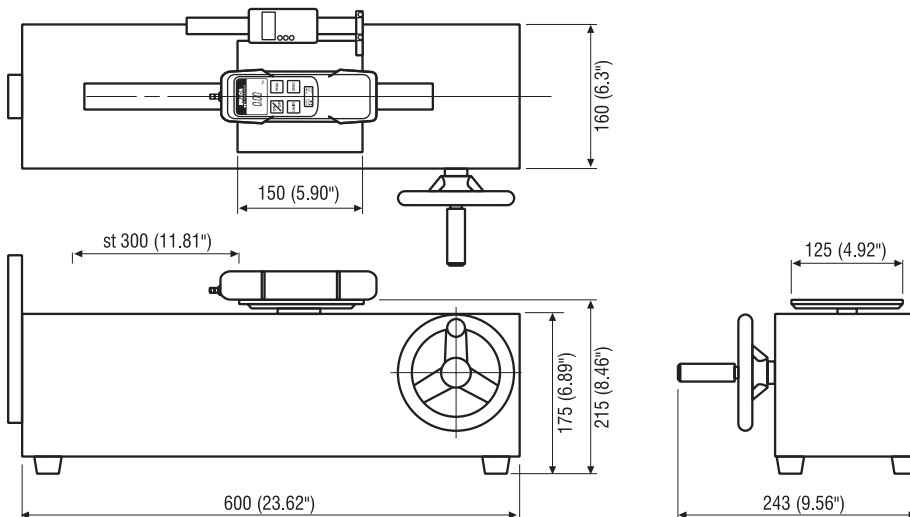

Force gauge sold separately
Specifications subject to change without notice.